

# BAJOMESADA 40 EXPRESS



ITEM	DESCRIPCIÓN	CANT.
P1	FAJA BM 40	2
P2	COSTADO - STD	2
P3	BASE BM 40	1
P4	FONDO BM 120-160	1
P5	PUERTA BM 120 - 160	1
P6	ESTANTE SUELTO BM 40	1
P7	TAPA BM 40	1

ITEM	DESCRIPCIÓN	CANT.
H1	TARUGO Ø6 x 30	12
H2	TORNILLO 6.30 x 50 CABEZA ALLEN	8
H3	PATA BAJOMESADA	4
H4	TORNILLO PLASTICO PATAS	4
H5	CLAVO 8 X 20	16
H6	MARCA EMPRESARIAL PLASTICA	1
H7	SOPORTE ESTANTE METALICO 5MM	4
H8	TORNILLO 3.5 x 30	2
H9	MANIJA BENETHON 160mm	1
H10	TORNILLO 3.5 x 15	8
H11	BISAGRA Ø26 CODO 9	2
H12	LLAVE ALLEN 4MM	1
H13	SACHET DE COLA 10 grs	1

## PREPARACION DE PIEZAS.

- Lijar suavemente las aristas.
- Limpiar las piezas con un paño
- Aplicar lustra muebles a todas la piezas

Las piezas llevan impreso el N° de LOTE el cual le será requerido al momento de realizar alguna consulta o reclamo a nuestro servicio.

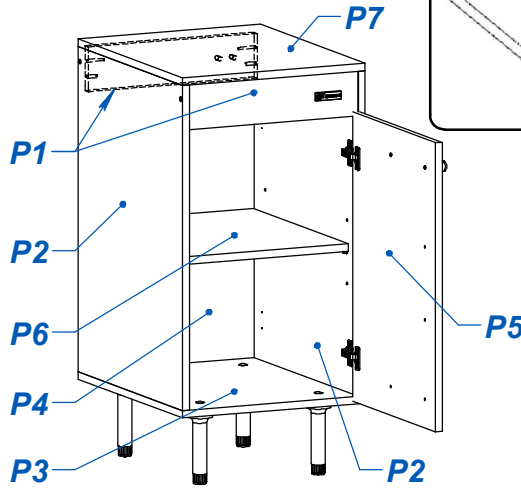
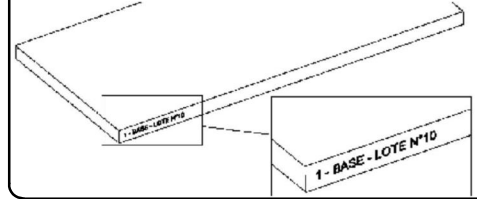

## VIDEO DE ARMADO

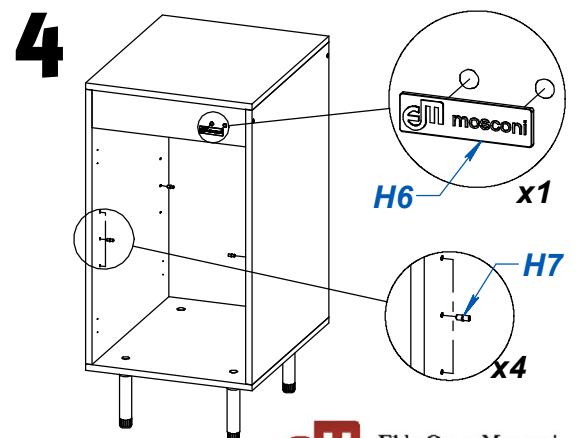
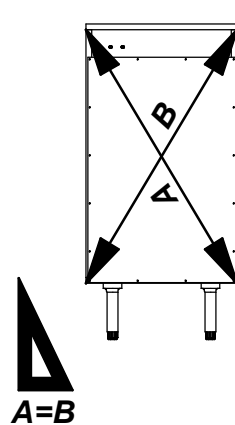
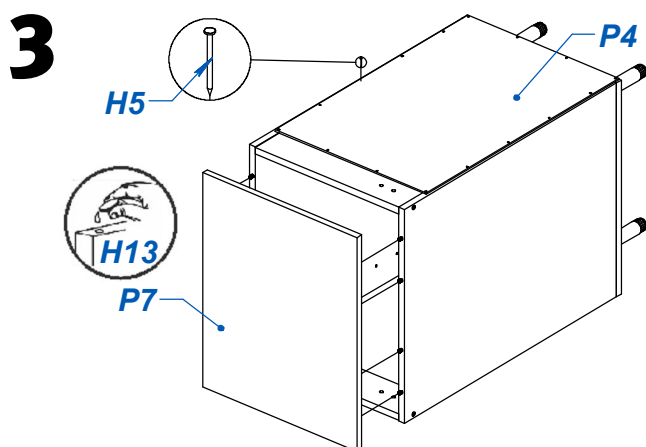
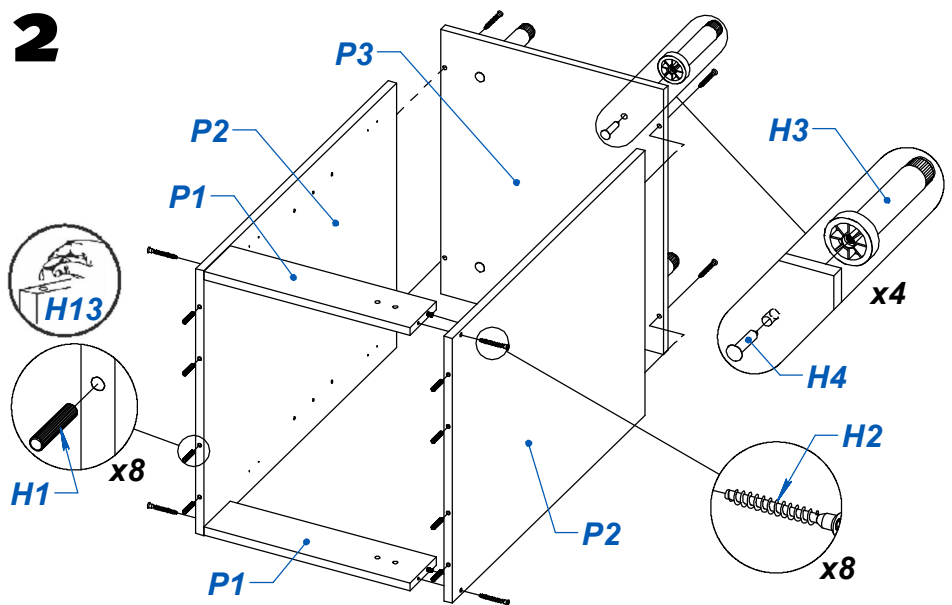
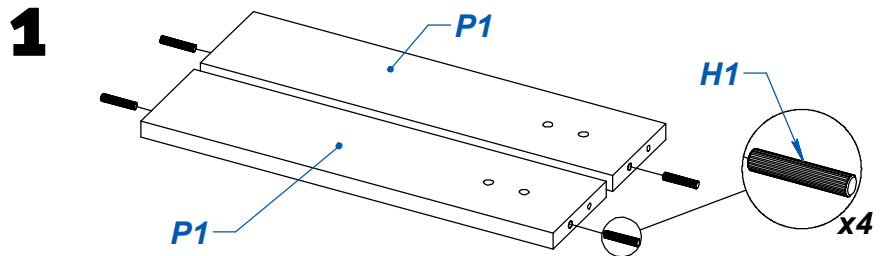
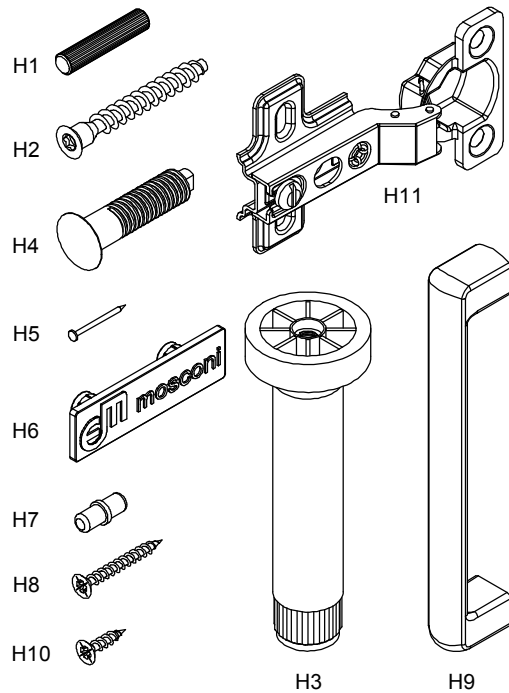

# 5-der

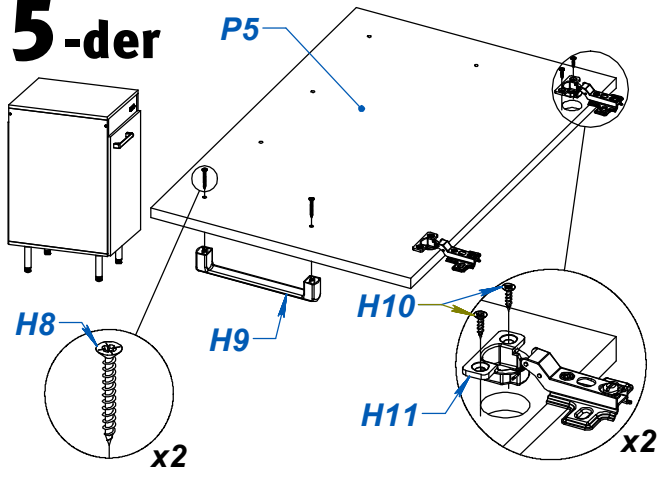

# 5-izq

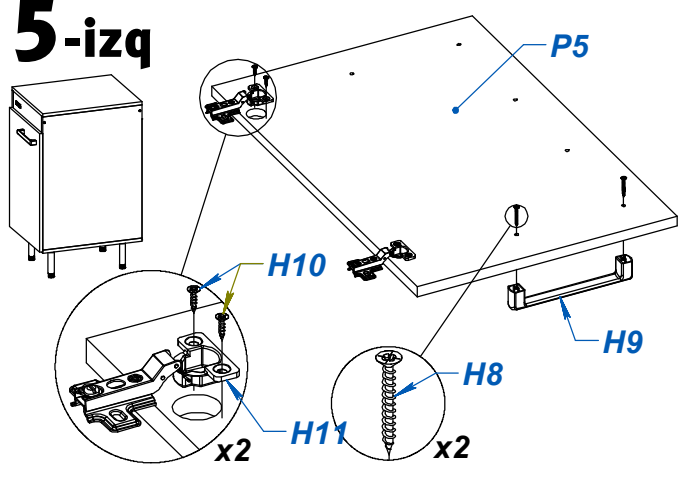

# POSICION MANIJA

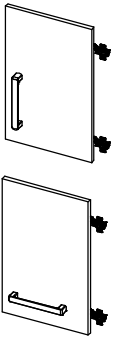

# 6

